



WELCOME TO AFREZZA[®]

YOU'RE STARTING A NEW TREATMENT JOURNEY.
HERE'S WHAT TO EXPECT.



THE ONLY INHALED MEALTIME
INSULIN FOR ADULTS AND CHILDREN
6 YEARS AND OLDER LIVING WITH DIABETES



Scan to see Medication Guide and Instructions for Use. See Important Safety Information, including BOXED WARNING, on pages 14-15 of this brochure. Visit www.afrezza.com/safety to see full Prescribing Information.

IN THIS GUIDE:

- 1 Welcome to Afrezza**
- 3 Dosing Afrezza**
 Fill out a Mealtime Plan with your doctor on page 4
- 5 Taking Afrezza**
- 11 Storage and Handling**
- 12 Prescription Help**
- 14 FAQs and More**
- 16 Important Safety Information**



IMPORTANT SAFETY INFORMATION

WHAT IS THE MOST IMPORTANT INFORMATION I SHOULD KNOW ABOUT AFREZZA®?

Afrezza can cause serious side effects, including:

- Sudden lung problems (bronchospasms). In a study, some Afrezza-treated patients with asthma, whose asthma medication was temporarily withheld, experienced sudden lung problems. Do not use Afrezza if you have long-term (chronic) lung problems such as asthma or chronic obstructive pulmonary disease (COPD). Before starting Afrezza, your healthcare provider will give you a breathing test to check how your lungs are working.

WHAT IS AFREZZA?

- Afrezza is a man-made insulin that is breathed-in through your lungs (inhaled) and is used to control high blood sugar in adults and children 6 years of age and older with diabetes mellitus.
- Afrezza is not for use to treat diabetic ketoacidosis. Afrezza must be used with basal insulin in people who have type 1 diabetes mellitus.
- It is not known if Afrezza is safe and effective for use in people who smoke. Afrezza is not for use in people who smoke or have recently stopped smoking (less than 6 months).
- It is not known if Afrezza is safe and effective in children under 6 years of age.

WHO SHOULD NOT USE AFREZZA?

Do not use Afrezza if you:

- Are having an episode of low blood sugar (hypoglycemia).
- Have chronic lung problems such as asthma or COPD.
- Are allergic to regular human insulin or any of the ingredients in Afrezza.

WHAT SHOULD I TELL MY HEALTHCARE PROVIDER BEFORE USING AFREZZA?

Before using Afrezza, tell your healthcare provider about all your medical conditions, including if you:

- Have lung problems such as asthma or COPD.
- Have or have had lung cancer.
- Are using any inhaled medications.
- Smoke or have recently stopped smoking.
- Have kidney or liver problems.
- Are pregnant, planning to become pregnant, or are breastfeeding. Afrezza may harm your unborn or breastfeeding baby.

Tell your healthcare provider about all the medicines you take, including prescription and over-the-counter medicines, vitamins, or herbal supplements.

Before you start using Afrezza, talk to your healthcare provider about low blood sugar and how to manage it.

WHAT SHOULD I AVOID WHILE USING AFREZZA?

While using Afrezza do not:

- Drive or operate heavy machinery, until you know how Afrezza affects you.
- Drink alcohol or use over-the-counter medicines that contain alcohol.
- Smoke.

Please see Medication Guide, Instructions for Use, and Important Safety Information on pages 14-15 of this brochure, or visit www.afrezza.com/safety



WELCOME TO AFREZZA®



As someone who depends on mealtime insulin, you know flexibility is important:

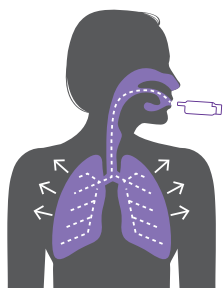

Did you know it's faster to get insulin into your bloodstream through the lungs than when injected under your skin?

Inhaled insulin passes through your lungs into your blood, and it starts working to lower blood sugar fast.*



ULTRA RAPID ABSORPTION

When Afrezza insulin is inhaled, it enters through the large surface area of the lungs, enabling ultra rapid absorption.

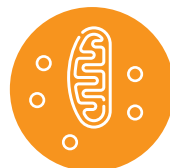

MORE CLOSELY MIMICS NATURAL INSULIN RESPONSE

Afrezza uses a unique formulation to deliver insulin into the bloodstream via the lungs.

- **< 1 minute:** Insulin is absorbed
- **~ 12 minutes:** Starts lowering blood sugar
- **Approximately 35–45 minutes[†]:** Time to peak effect

* Your prescriber will determine proper dosing. Please always consult with your prescriber prior to changing dose.

[†] For the 4 Afrezza unit and 12 Afrezza unit cartridges



DO MEALTIME ON YOUR TIME

- Afrezza lets you inhale your insulin right when food arrives
- Spontaneous but still in control
- No pre-bolusing
- Leaves the body within 1.5 to 3 hours.* Depending on the dose, you have the option to take additional correction doses at 1 and 2 hours after meals, if needed.

NO MEALTIME NEEDLESTICKS NECESSARY

- Eliminates over 1,000 mealtime injections per year[†]
- Scar tissue can be a problem for people with diabetes, developing under the skin as a result of repeated injections.
- Scar tissue can affect the body's ability to absorb insulin and can cause serious complications.

* For the 4 Afrezza unit and 12 Afrezza unit cartridges

[†] Assumes 1 needle per meal, 3 meals per day for 365 days, rounded down.





Complete your
MEALTIME PLAN
on the next page
with your doctor.

DOSING AFREZZA®

Afrezza is available in 4-, 8-, and 12-unit color-coded cartridges. Your prescribed dose may require one cartridge or a combination of cartridges.



4 UNITS



8 UNITS



12 UNITS

INITIAL DOSING WITH CARTRIDGES

If you've had experience with mealtime injections, use this conversion chart on the right to help determine the correct amount of Afrezza insulin units you need.

EFFECTIVE DOSING





To achieve a comparable glucose lowering effect to your current injectable insulin, you may need to consult your healthcare provider to adjust your dose, up or down, based on your blood sugar levels and how Afrezza works for you. Like all insulin therapy, monitor the effect Afrezza has on you.

INJECTED MEALTIME INSULIN DOSE	AFREZZA DOSE	CARTRIDGE(S)
UP TO 3 UNITS	4 UNITS	
4-5 UNITS	8 UNITS	
6-7 UNITS	12 UNITS	
8 UNITS & UP	16 UNITS	 8 UNITS + 8 UNITS OR 4 UNITS + 12 UNITS

MY MEALTIME PLAN

STEP 1:

Work with your doctor to determine the dosing regimen that's right for you, then record it here:

MEAL	APPROX. CARBS	MY AFREZZA DOSE	CARTRIDGE(S)
 SMALL SNACK	0-15* GRAMS CARBS	UNITS	
 SMALL MEAL	15-30* GRAMS CARBS	UNITS	
 MEDIUM MEAL	30-45* GRAMS CARBS	UNITS	
 LARGE/XL MEAL	45-90* GRAMS CARBS	UNITS	

* Carbohydrate amounts are estimates and may vary depending on the ingredients. Check food labels for accurate carbohydrate amounts. Source: USDA FoodData Central, <https://fdc.nal.usda.gov/>

† American Diabetes Association suggests 1-2 hours after beginning of the meal. The American Association of Clinical Endocrinologists suggests 2 hours after beginning of the meal.

STEP 2:

Check blood sugar to see HOURS AFTER BEGINNING OF THE MEAL[†] how Afrezza is working for you

STEP 3:

Take a correction dose, if needed.

AFTER-MEAL BLOOD SUGAR	CORRECTION DOSE
<p>BETWEEN</p> <p>TARGET <input type="text"/> MG/DL - <input type="text"/> MG/DL</p>	NO CORRECTION DOSE NEEDED
<p>GREATER THAN</p> <p><input type="text"/> MG/DL</p>	<p>TAKE</p> <p><input type="text"/> UNITS</p>

STEP 4:

Adjust dose, if needed.

- DAYS After this many days, if your after-meal blood sugar remains above your target blood sugar range, consult your doctor to consider increasing your dose in Step 1.
- Continue adjusting until your after-meal blood sugar is consistently within your target.



TAKING AFREZZA[®]

(IN 4 STEPS)

A STEP-BY-STEP GUIDE TO YOUR FIRST DOSE

Learn how to take a dose and store Afrezza at home or on the go.

Please have dosing instructions from your healthcare provider ready before taking Afrezza and ensure you have the right number of Afrezza cartridges for your dose available before you start.

Scan here for
instructions on
how to use Afrezza



1. SELECT CARTRIDGE

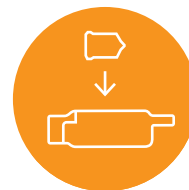

2. LOAD CARTRIDGE



3. INHALE INSULIN

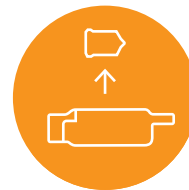

4. REMOVE USED CARTRIDGE



1. SELECT CARTRIDGE



Before use, cartridges and inhaler should be at room temperature for 10 minutes.

Follow the dosing instructions from your healthcare provider. If your prescribed Afrezza dose is more than 12 units you will need to use more than one cartridge to get your right dose.

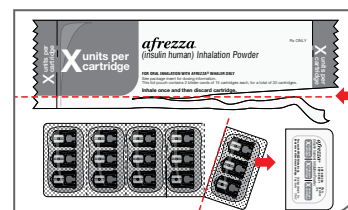

■ **OPEN PACKAGES:** Remove a blister card from the foil package. Tear along perforation to remove one strip.

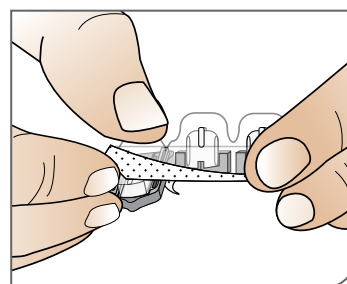

■ **PUSH CARTRIDGES TO REMOVE:** Remove a cartridge from the strip by pressing on the clear side to push the cartridge out. Remove the right number of cartridges for your dose. Pushing on the cup will not damage the cartridge.

Afrezza cartridges left over in an opened strip must be used within three days



2. LOAD CARTRIDGE

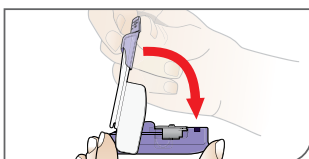
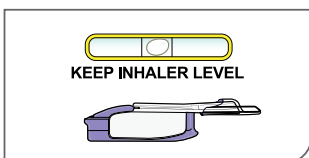
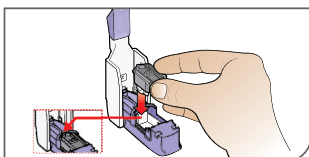
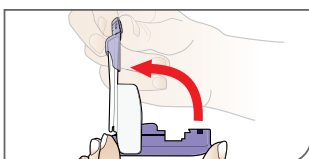
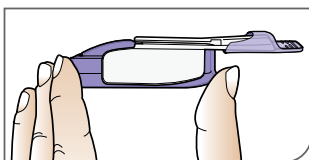

- **HOLD INHALER:** Hold the inhaler level in one hand with the white mouthpiece on the top and purple base on the bottom.
- **OPEN INHALER:** Open the inhaler by lifting the white mouthpiece to a vertical position. Before you put the Afrezza cartridge in your inhaler, make sure it has been at **room temperature for 10 minutes**.
- **PLACE CARTRIDGE:** Hold the cartridge with the cup facing down. The pointed end of the cartridge should line up with the pointed end in the inhaler. Place cartridge into the inhaler, making sure it lies flat in inhaler.
- **KEEP LEVEL:** Now that the cartridge is loaded, keep the inhaler level from this point forward to avoid loss of drug powder. Do not turn it upside down, shake, or drop, as this could cause a loss of drug powder.
- **CLOSE INHALER:** Lower the mouthpiece to close the inhaler (this will open the drug cartridge). You should feel a snap when the inhaler is closed.



QUICK TIP

Since Afrezza is an inhaled powder, it is not uncommon to experience cough at the beginning of your treatment. In our clinical studies, cough was mild and the incidence was highest within the first week of Afrezza treatment and declined over the following 4–8 weeks. As a suggestion, taking Afrezza at room temperature and having a sip of water before inhalation may help. If you develop a persistent or recurring cough, or have breathing difficulties while using Afrezza, contact your healthcare provider.

3. INHALE INSULIN

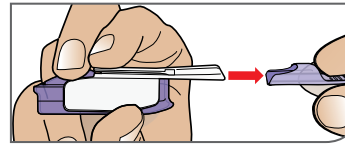

■ **REMOVE COVER:** Remove the mouthpiece cover. Keep the inhaler level.

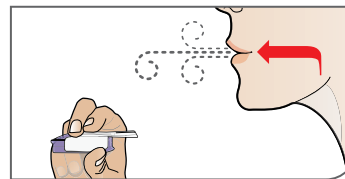

■ **EXHALE:** Hold the inhaler away from your mouth and exhale fully.

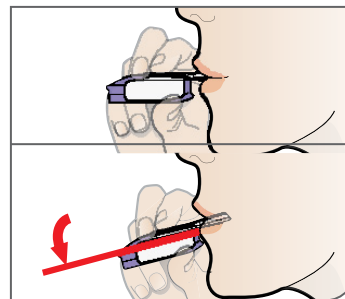

■ **POSITION INHALER:** Keeping your head and inhaler level, place the mouthpiece in your mouth. Close your lips around the mouthpiece to form a seal. Tilt the inhaler downward while keeping your head level as shown.

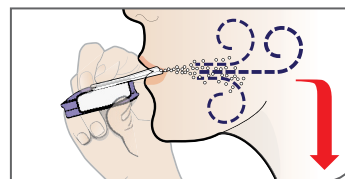

■ **INHALE DEEPLY AND HOLD BREATH:** With your mouth closed around the mouthpiece, inhale deeply through the inhaler. Hold your breath for as long as comfortable and at the same time remove the inhaler from your mouth. Exhale and breathe normally.



4. REMOVE USED CARTRIDGE

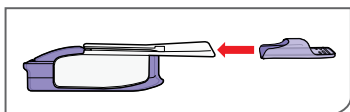

- **REPLACE MOUTHPIECE COVER:**

Place the purple mouthpiece cover back onto the inhaler.

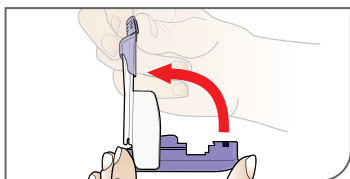

- **OPEN INHALER:** Open the inhaler by lifting up the white mouthpiece.

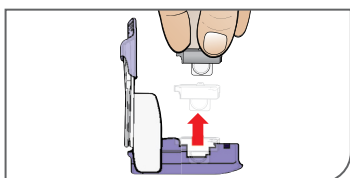

- **REMOVE CARTRIDGE:** Remove the cartridge from the purple base.

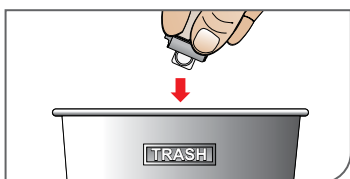

- **RECYCLE THE CARTRIDGE:** Since it is composed of HDPE, assigned recycling number 2, the used cartridge can be recycled.

QUICK TIP



A small amount of powder residue in the mouthpiece or cartridge is normal. This does not affect your dose. You can wipe the mouthpiece with a clean, dry cloth to remove moisture or lipstick. Do not wash the Afrezza inhaler.



STORAGE AND HANDLING

IN USE: ROOM TEMPERATURE STORAGE

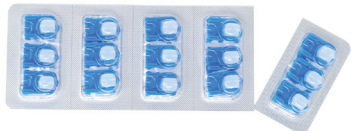
Reference the chart below for instructions on taking care of your inhaler and opened foil packages.

OPENED AFREZZA INHALERS	Room Temperature
	Use for up to 15 days from the date of first use. After 15 days, inhaler must be discarded and replaced.
SEALED BLISTER CARDS + STRIPS	Room Temperature
	Must be used within 10 days
OPENED STRIPS	Room Temperature
	Must be used within 3 days

Do not put a blister card or strip back into the refrigerator after being stored at room temperature.

NOT IN USE: REFRIGERATED STORAGE

Store unopened drug in a refrigerator 36°F-46°F (2°C-8°C).

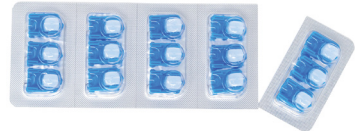
SEALED FOIL PACKAGES	Refrigerated
	May be used until the expiration date*
SEALED BLISTER CARDS + STRIPS	Refrigerated
	Must be used within 1 month*

 Before use, cartridges and inhaler should be at room temperature for 10 minutes.

* If a foil package, blister card, or strip is not refrigerated, the contents must be used within 10 days.



97% OF PATIENTS PAY \$35 OR LESS FOR AFREZZA*

4 PAYMENT PATHWAYS:

mannkindCares®

Call to find the best cost assistance program for you:



844-323-7399

(M-F, 8am-8pm ET)

APPROVED THROUGH
COMMERCIAL INSURANCE
(through your job or private plan)

Pay as **\$35** PER MONTH
little as **\$35** PER MONTH
with the Afrezza Savings Card**

APPROVED THROUGH
MEDICARE OR MEDICAID

Pay **\$35** OR LESS PER MONTH

NEW PATIENTS AGES 6-23

Pay **\$35** PER MONTH
through the Pediatric Bridge Program†

New patients only. While pursuing insurance approval.
Expires 12/31/2026.

UNINSURED
OR DO NOT QUALIFY
FOR OTHER PROGRAMS

Pay **\$99** PER BOX††

* Based on 2025 prescriptions filled. Your cost depends on your insurance plan and eligibility for cost assistance programs.
** Savings card valid for commercially insured patients only. Not for federal/state program enrollees. Terms at [AfrezzaSavingsCard.com](https://www.afrezza.com/savingscard).
† Pediatric Bridge Program available 6/1/26-12/31/26 exclusively through MannKind Cares. Terms at [Afrezza.com](https://www.afrezza.com).
†† Cash pay program \$99/box. Void where prohibited.

WHAT MANKIND CARES DOES FOR YOU

- Helps you find your best cost option based on your insurance or cash pay.
- Checks your eligibility for savings cards or bridge programs.
- Enrolls you in the right program over the phone.
- Arranges home delivery through a network pharmacy.
- Provides live training from a Patient Navigator.

We offer in-person* and virtual appointments.

Call MannKind Cares at [844-323-7399](tel:844-323-7399) to schedule.



Still have questions?
Call us!

mannkind Cares®

844 323-7399

(M-F, 8am-8pm ET)



Scan here for instructions
on how to use Afrezza

* In person training available
only in select locations.
Call for details.





FAQs

Q: IS AFREZZA® RIGHT FOR ME?

A: Afrezza is an ultra rapid-acting inhaled insulin used to control blood sugar in adults and children 6 years and older living with diabetes. It is not for people with certain types of lung disease (such as asthma or COPD) or who smoke. Do not use Afrezza if you are allergic to regular human insulin or any of the ingredients in Afrezza. Consult with your healthcare provider to determine if Afrezza is right for you.

Q: WHEN SHOULD I TAKE MY AFREZZA?

A: Afrezza should be inhaled at the beginning of a meal because it more closely mimics natural insulin response.

Q: WHAT SHOULD I DO IF I EXPERIENCE A COUGH?

A: Since Afrezza is an inhaled powder, it is not uncommon to experience cough at the beginning of your treatment. In our clinical studies, cough was mild and typically declined with continued use after 4–8 weeks. As a suggestion, taking Afrezza at room temperature and having a sip of water before inhalation may help. If you develop a persistent or recurring cough, or have breathing difficulties while using Afrezza, contact your healthcare provider.

Additional questions? Visit www.afrezza.com/faqs



IMPORTANT SAFETY INFORMATION

WHAT IS THE MOST IMPORTANT INFORMATION I SHOULD KNOW ABOUT AFREZZA®?

Afrezza can cause serious side effects, including:

- Sudden lung problems (bronchospasms). In a study, some Afrezza-treated patients with asthma, whose asthma medication was temporarily withheld, experienced sudden lung problems. Do not use Afrezza if you have long-term (chronic) lung problems such as asthma or chronic obstructive pulmonary disease (COPD). Before starting Afrezza, your healthcare provider will give you a breathing test to check how your lungs are working.

WHAT IS AFREZZA?

- Afrezza is a man-made insulin that is breathed-in through your lungs (inhaled) and is used to control high blood sugar in adults, and children 6 years of age and older with diabetes mellitus.
- Afrezza is not for use to treat diabetic ketoacidosis. Afrezza must be used with basal insulin in people who have type 1 diabetes mellitus.
- It is not known if Afrezza is safe and effective for use in people who smoke. Afrezza is not for use in people who smoke or have recently stopped smoking (less than 6 months).
- It is not known if Afrezza is safe and effective in children under 6 years of age.

WHO SHOULD NOT USE AFREZZA?

Do not use Afrezza if you:

- Are having an episode of low blood sugar (hypoglycemia).
- Have chronic lung problems such as asthma or COPD.

- Are allergic to regular human insulin or any of the ingredients in Afrezza.

WHAT SHOULD I TELL MY HEALTHCARE PROVIDER BEFORE USING AFREZZA?

Before using Afrezza, tell your healthcare provider about all your medical conditions, including if you:

- Have lung problems such as asthma or COPD.
- Have or have had lung cancer.
- Are using any inhaled medications.
- Smoke or have recently stopped smoking.
- Have kidney or liver problems.
- Are pregnant, planning to become pregnant, or are breastfeeding. Afrezza may harm your unborn or breastfeeding baby.

Tell your healthcare provider about all the medicines you take, including prescription and over-the-counter medicines, vitamins or herbal supplements.

Before you start using Afrezza, talk to your healthcare provider about low blood sugar and how to manage it.

WHAT SHOULD I AVOID WHILE USING AFREZZA?

While using Afrezza do not:

- Drive or operate heavy machinery, until you know how Afrezza affects you.
- Drink alcohol or use over-the-counter medicines that contain alcohol.
- Smoke.



WHAT ARE THE POSSIBLE SIDE EFFECTS OF AFREZZA?

See "What is the most important information I should know about Afrezza?" Afrezza may cause serious side effects that can lead to death, including:

Low blood sugar (hypoglycemia). Signs and symptoms that may indicate low blood sugar include:

- Dizziness or light-headedness, sweating, confusion, headache, blurred vision, slurred speech, shakiness, fast heartbeat, anxiety, irritability or mood change, hunger.

Decreased lung function. Your healthcare provider should check how your lungs are working before you start using Afrezza, 6 months after you start using it, and yearly after that.

Lung cancer. In studies of Afrezza in people with diabetes, lung cancer occurred in a few more people who were taking Afrezza than in people who were taking other diabetes medications. There were too few cases to know if lung cancer was related to Afrezza. If you have lung cancer, you and your healthcare provider should decide if you should use Afrezza.

Diabetic ketoacidosis. Talk to your healthcare provider if you have an illness. Your Afrezza dose or how often you check your blood sugar may need to be changed.

Severe allergic reaction (whole body reaction). Get medical help right away if you have any of these signs or symptoms of a severe allergic reaction:

- A rash over your whole body, trouble breathing, a fast heartbeat, or sweating.

Low potassium in your blood (hypokalemia).

Heart failure. Taking certain diabetes pills called thiazolidinediones or "TZDs" with Afrezza may cause heart

failure in some people. This can happen even if you have never had heart failure or heart problems before. If you already have heart failure it may get worse while you take TZDs with Afrezza. Your healthcare provider should monitor you closely while you are taking TZDs with Afrezza. Tell your healthcare provider if you have any new or worse symptoms of heart failure including:

- Shortness of breath, swelling of your ankles or feet, sudden weight gain.

Treatment with TZDs and Afrezza may need to be changed or stopped by your healthcare provider if you have new or worse heart failure.

Get emergency medical help if you have:

- Trouble breathing, shortness of breath, fast heartbeat, swelling of your face, tongue, or throat, sweating, extreme drowsiness, dizziness, confusion.

The most common side effects of Afrezza include:

- Low blood sugar (hypoglycemia), cough, sore throat.

These are not all the possible side effects of Afrezza. Call your doctor for medical advice about side effects.

You are encouraged to report negative side effects of prescription drugs to the FDA. Visit www.fda.gov/medwatch, or call 1-800-FDA-1088 (1-800-332-1088).

Please see Medication Guide and Instructions for Use. On pages 14-15, see Important Safety Information or visit www.afrezza.com/safety.

Afrezza, the Afrezza logo, AfrezzaAssist and logo, MannKind and MannKind Cares are registered trademarks of MannKind Corporation. © MannKind Corporation May 2026. US-AFR-3026



 **afrezza**[®]
(insulin human) Inhalation Powder



Scan to see Medication Guide and Instructions for Use.
See Important Safety Information, including **BOXED WARNING**, on pages 14-15 of this brochure. Visit www.afrezza.com/safety to see full Prescribing Information.

Afrezza, MannKind, MannKindCares,
and their respective logos are registered trademarks
of MannKind Corporation.

© MannKind Corporation May 2026. US-AFR-3026